

## CORNER RESTORATION

CORNER NE Cor.  
Sec. 29 TWP 17S., RANGE 28E., W.M.

ORIGINAL SURVEY BY: Henry W. Cooke

CONTRACT NUMBER: 427

CONTRACT DATE: Dec. 15, 1881

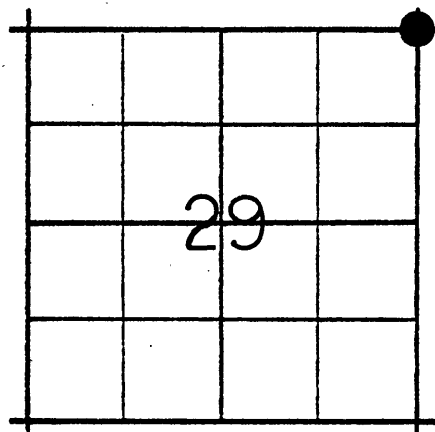

**ORIGINAL DESCRIPTION:**

80.00 Point 800 ft. above river and  
 Set a basalt stone 16x10x5 ins. 11 ins. in the ground for cor to  
 secs. 20, 21, 28, and 29 marked with 2 notches on south and 4 notches  
 on Eas sides- dug pits 18x18x12 ins. in each sec. 5 1/2 ft. dist and raised  
 a mound of earth alongside, 3 ft. high 4 1/2 ft. base.

RESTORATION BY, STAMP AND DATE:

REGISTERED  
 PROFESSIONAL  
 LAND SURVEYOR

*Robert D. Bagett*  
 OREGON  
 JULY 12, 1963  
 ROBERT D. BAGETT  
 598

**RECEIVED AND  
 FILED**

DEC 10 1975  
*John Liveira*  
 JOHN LIVEIRA, County Clerk  
 By \_\_\_\_\_ Deputy

November 20, 1975

Grant County Surveyor

**EVIDENCE FOUND:**

Found a basalt stone 16"x10"x5" marked with 4 notches on one side and  
 2 notches on other side firmly set 4 ins. in ground.

**DESCRIPTION OF MONUMENTS AND ACCESSORIES SET AND METHODS USED:**

Show how trees are scribed and basis of bearings, including compass var.

Set a 1 1/2"x30" iron pipe 18" in the ground with brass cap marked as shown:  
 from which I scribe NEW BEARING TREE:

A juniper, 18" diam., bears S43°W., 20.4 ft., marked  
 T17S R28E S29 CSBT.

I used a compass with 20° E. variation and a steel  
 tape, measuring to the face of the BT blaze.

MONUMENT MARKED

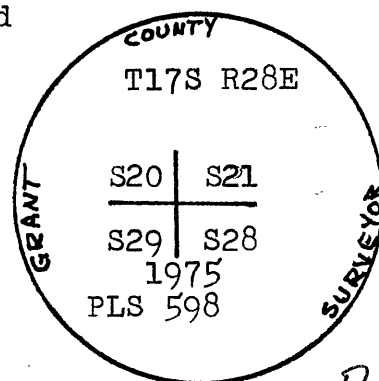

Complete and File with Office of the Grant  
 County Surveyor, Grant County, Oregon,  
 Courthouse, Canyon City, Oregon 97820